



## SPECIFICATIONS

**RATING:** 30mA / 28VDC

**OPERATING SPEED:** 10mm/sec

**ELECTRIC LIFE:** 20,000 cycles

**FULL TRAVELS:** 2.0mm

**OPERATING TEMPERATURE:** -40°C to 95°C

## MATERIALS

**PUSHER:** POM Black

**DUST PROTECTION CAP:** POM Black

**CASE:** PA Nature glass fiber reinforced

**SPRING:** Piano wire

**CONTACT/TERMINALS:** Brass, silver plated



## SWITCH FUNCTION

### SPST

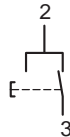

### SPDT

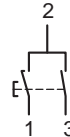

## POLE OPTIONS

### SPST

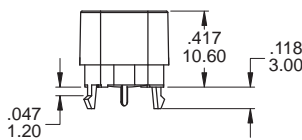
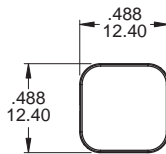

Part No. Shown : PS3001

#### NOTE

Force: G3.4~6.4N

Operating position: 8.9 ± 0.2mm

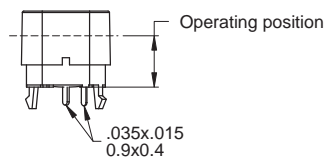

#### P.C. MOUNTING

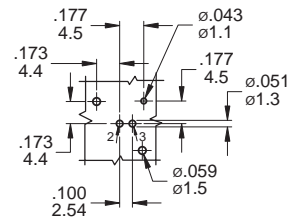

### SPDT

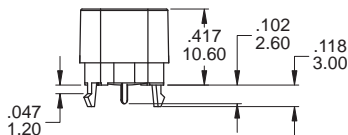
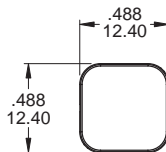

Part No. Shown : PS3002

#### NOTE

Force 1: G5~7N

Force 2: G11~14N

Operating position 1: 9.7 ± 0.2mm

Operating position 2: 8.9 ± 0.2mm

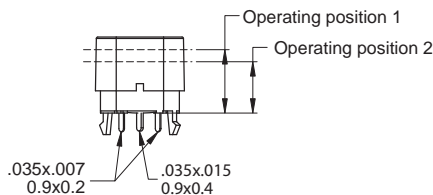

#### P.C. MOUNTING

