



SPECIFICATIONS

RATING: DC9V,1A

MECHANICAL LIFE: S7/D7: 20,000 cycles
 SL/DL: 10,000 cycles
 37/3L: 30,000 cycles

CONTACT RESISTANCE: 50 mΩ MAX. / 30mΩ MAX. (FK37/3L)

INSULATION RESISTANCE: DC 500V 100MΩ MIN.

DIELECTRIC STRENGTH: 1,000 V RMS.@sea level.
 500V RMS @sea level.(FK37/3L)

OPERATING FORCE: S7: 1.7±0.7Kgf
 SL: 1.0±0.7Kgf (LOCK)
 D7: 2.5±0.8Kgf
 DL: 1.6±0.5Kgf (LOCK)
 37/3L: 3.0±0.8Kgf

OPERATING TEMPERATURE: -10°C to 70°C.



HOW TO ORDER

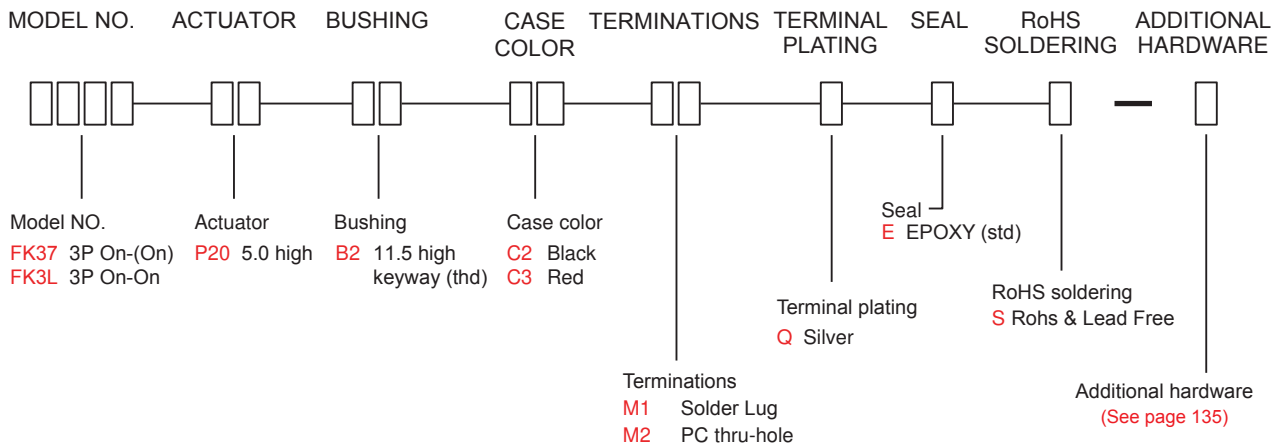
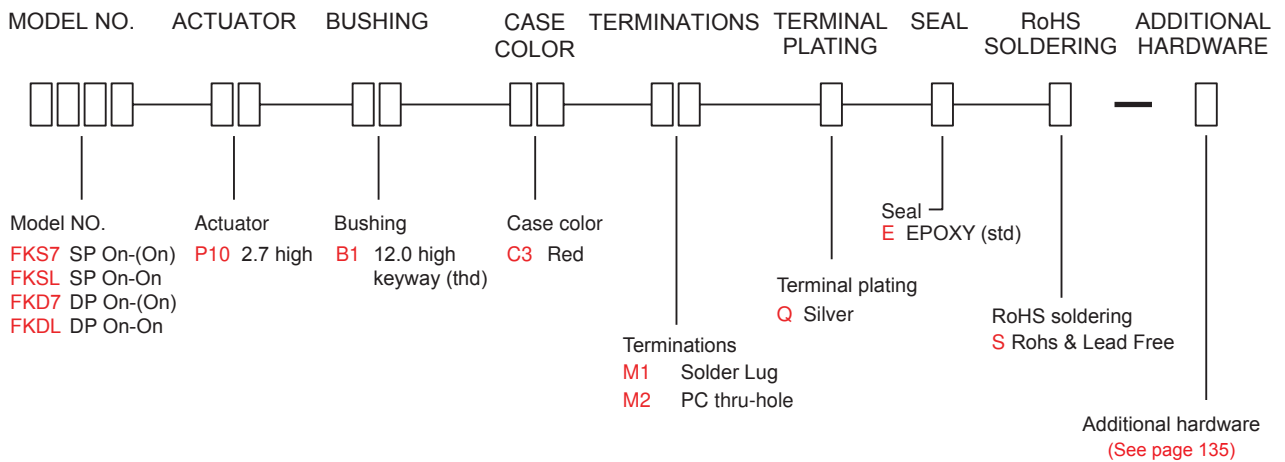

FK Pushbutton Switches

FK Series

Foot Switches

SWITCH FUNCTION

| NO. POLES | MODEL NO. | SWITCH FUNCTION | | CONNECTED TERMINALS / SCHEMATIC | |
|-----------|-----------|-----------------|-------|---------------------------------|-------------|
| | | POS.1 | POS.2 | POS.1 | POS.2 |
| | | | | | |
| SP | FKS7 | ON | (ON) | 2-1 | 2-3 |
| | FKSL | ON | ON | | |
| DP | FKD7 | ON | (ON) | 2-1,5-4 | 2-3,5-6 |
| | FKDL | ON | ON | | |
| 3P | FK37 | ON | (ON) | 2-1,5-4,8-7 | 2-3,5-6,8-9 |
| | FK3L | ON | ON | | |

()=MOMENTARY

TERMINATION OPTIONS

S7

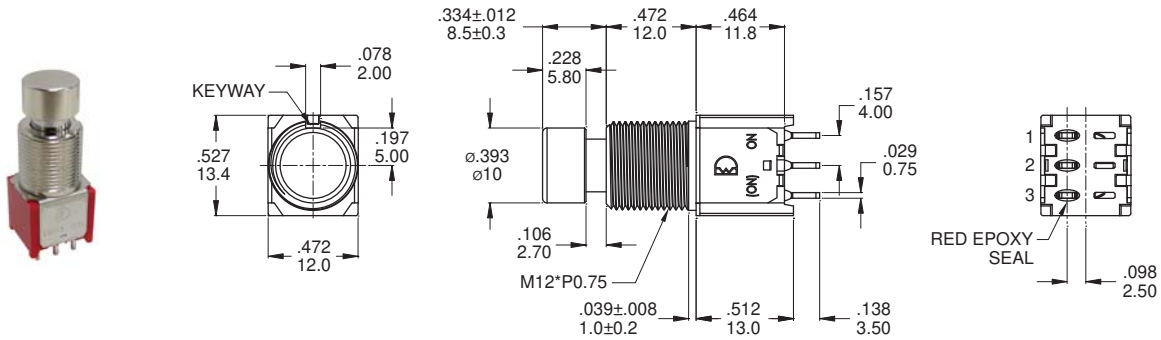

Part No. Shown : FKS7P10B1C3M1QES-5

DL

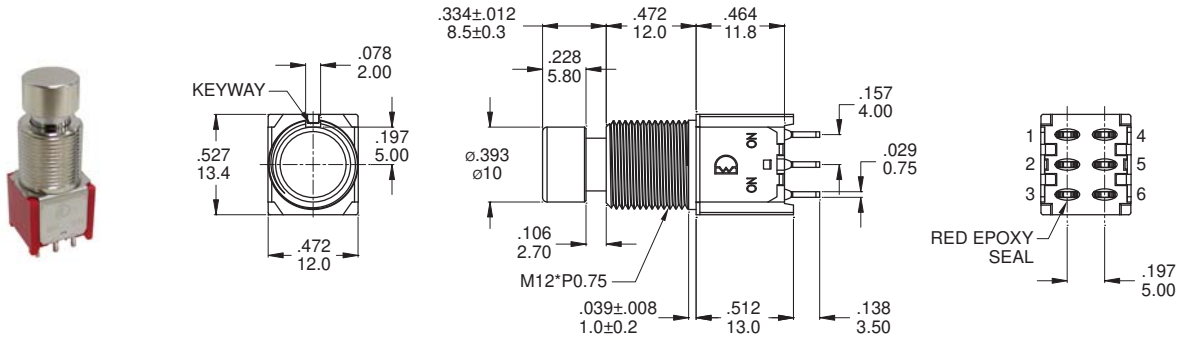

Part No. Shown : FKDLP10B1C3M2QES-5

3L

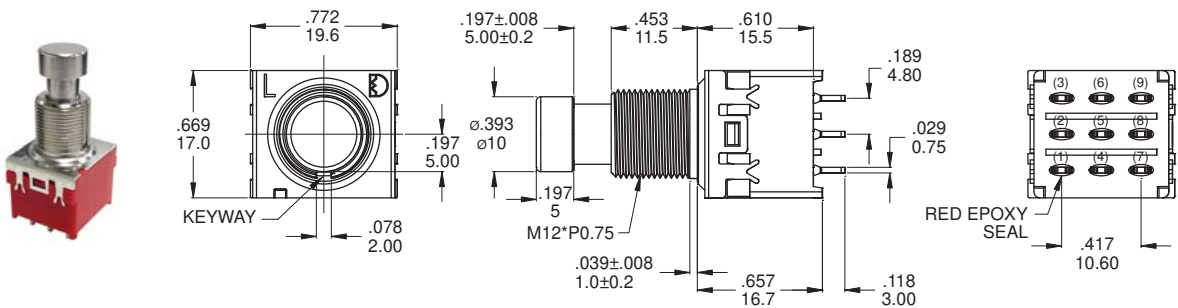

Part No. Shown : FK3LP20B2C3M2QES-5

FK Pushbutton Switches

TERMINATION OPTIONS

M1 Solder lug

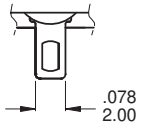

.029(0.75) THK.

M2 PC Thru-hole

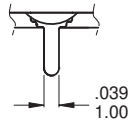

.029(0.75) THK.

P.C.B MOUNTING

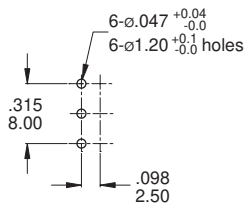

S7/SL

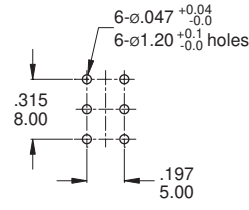

D7/DL

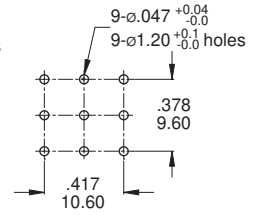

37/3L

HARDWARE

NUT

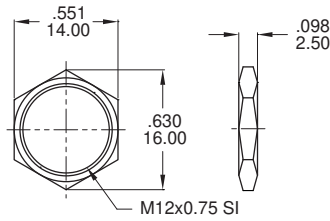

MNU-PA03

WASHE

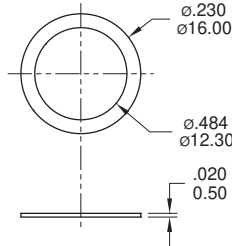

NU-7K01

TOOTH WASHE

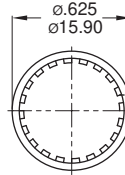

.039 THK
1.0

NU-1M09

PANEL MOUNTING

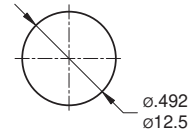

PUSHBUTTON SWITCH



SPECIFICATIONS

LIFE CYCLES: 20,000 cycles.

OPERATING FORCE: 650±200gf.cm

* Working force for bushing with nut: Test with torsion meter and increase torsion greater than 8kgf.cm.

* Stay-Nut torsion strength 8kgf.cm.

* 1 pc. of nut is packed separately.

PART NO.(P/N.)

FK-P1B1-5

Additional hardware
Bushing
Actuator

